

# West Friendship Volunteer Fire Department West Friendship, Maryland

## PROJECT PROFILE



The two-story West Friendship Fire Station #3 is a 41,000 SF fire station in Sykesville, Howard County, Maryland. The station will house members of the volunteer department, including both fire and EMS personnel. The unusual v-shape design of the station separates the fire apparatus from the EMS apparatus with two separate wings. The fire wing will contain three drive-through apparatus bays and one drive-through wash bay. The EMS wing will accommodate five back-in apparatus bays.

Principal-in-Charge of the project, Mark Stromdahl, believes that by separating the fire and EMS apparatus, we were able to make the most efficient use of space. Since the back-in EMS bays are smaller than the fire bays, the space behind the EMS bays is used for the bunk areas. It will provide for sleeping quarters for 21 people, a feature that is designed to attract trained college students looking for free room and board and for those who want to volunteer as firefighters.



The two apparatus wings will connect with administrative space, which will accommodate offices, a full weight and exercise room, lounge room, activity room, and full kitchen/dining room.



### Legend

1. Fire Apparatus
2. Weight Room
3. Television Room
4. Activity Room
5. Dining Room
6. Commons
7. Report Office
8. Bunk Rooms
9. Library
10. Laundry
11. EMS Apparatus
12. EMS Shop

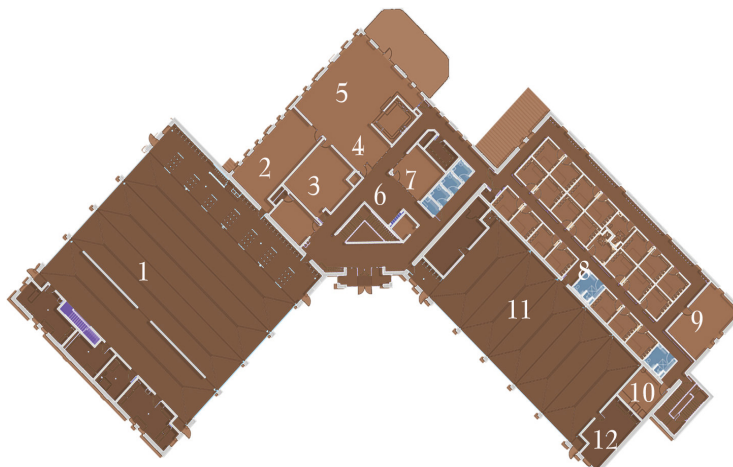

### Client:

West Friendship Volunteer  
Fire Department  
12535 Old Frederick Road  
Sykesville, MD 21784

### Project Type:

New Fire Station

### Location:

West Friendship,  
Maryland

### Size:

41,000 SF, 2 stories

### Status:

Completed 2009

### Role:

#### Full A/E Services:

- Site Evaluation
- Master Planning
- Construction Cost Projections
- Design
- Construction Documents
- Bidding/Negotiations
- Construction Administration

### Cost:

\$ 8,500,000 Construction  
\$ 700,000 Design

### Reference:

Chief Mickey Day,  
West Friendship  
Volunteer Fire  
Department  
410.313.5403

Edmeades & Stromdahl, Ltd.  
ARCHITECTS • PLANNERS

11 North Main Street • Bel Air MD 21014 • P 410.879.0388 • F 410.879.4785 • www.eslarch.com

